

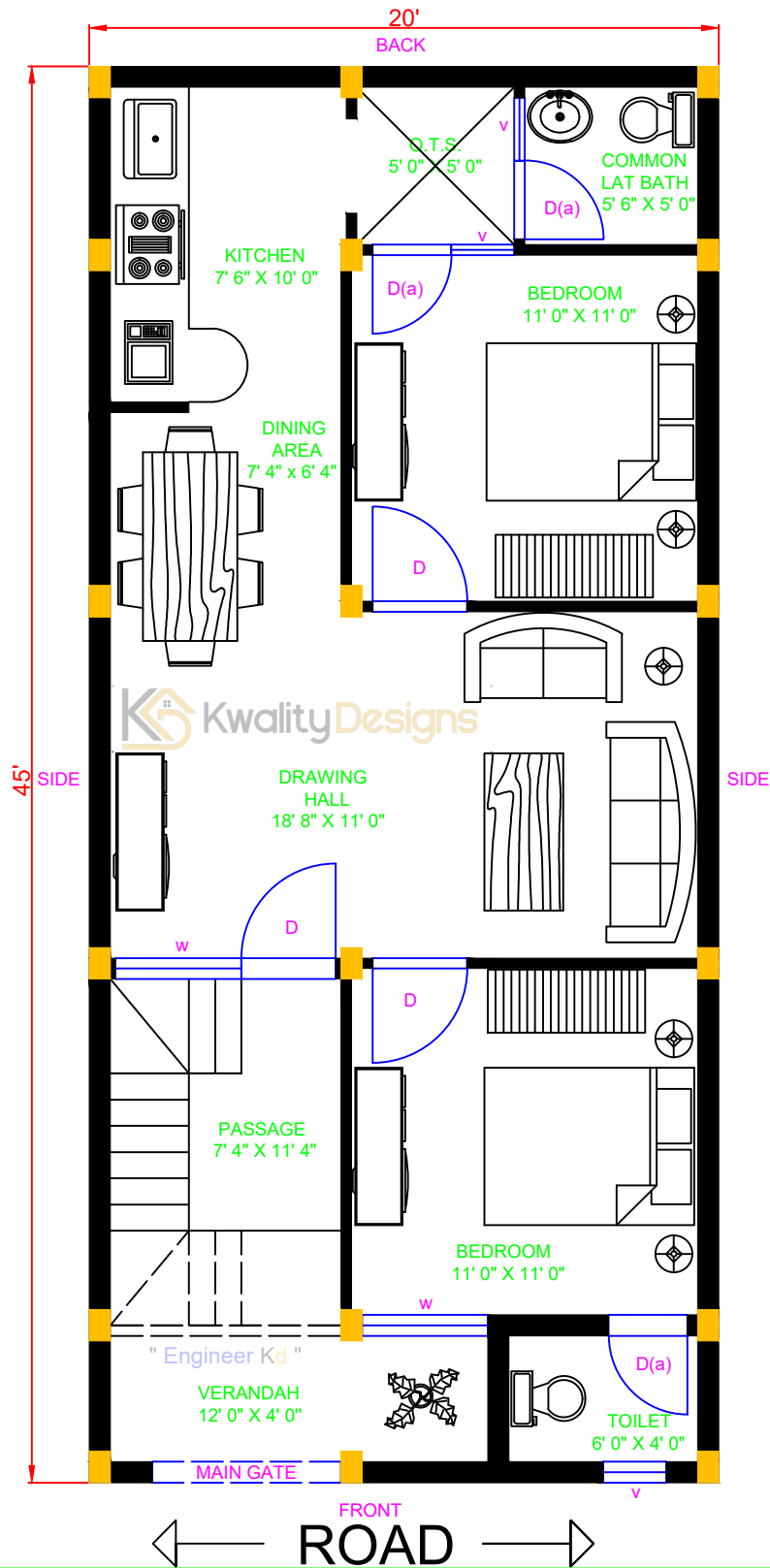

# NORTH FACING HOUSE GROUND FLOOR PLAN

20' X 45' FEET PLOT (900.00 Sqft.)



उत्तर मुखी घर का नक्शा



2D PLAN DETAILS	
COLUMN- 8" X 12"	OUTER WALL- 8"
DOOR (D)- 3' WIDE	INNER WALL- 4"
WINDOW (w)- 4' WIDE	STAIRS SIZE- 3' X 10"
	MAIN GATE- 6' WIDE
	DOOR D(a)- 2'6" WIDE
	VENT (V)- 2' WIDE
	CLIENT NAME : BHARAT CHAUHAN
	BANARAS



www.kwalitydesigns.com  
 engineerkdhome@gmail.com  
 "Engineer Kd"   
 Page & Channel Available on Instagram, Facebook & Youtube



# GROUND FLOOR MEASUREMENT DETAILS

20' X 45' FEET PLOT (900.00 Sqft.)

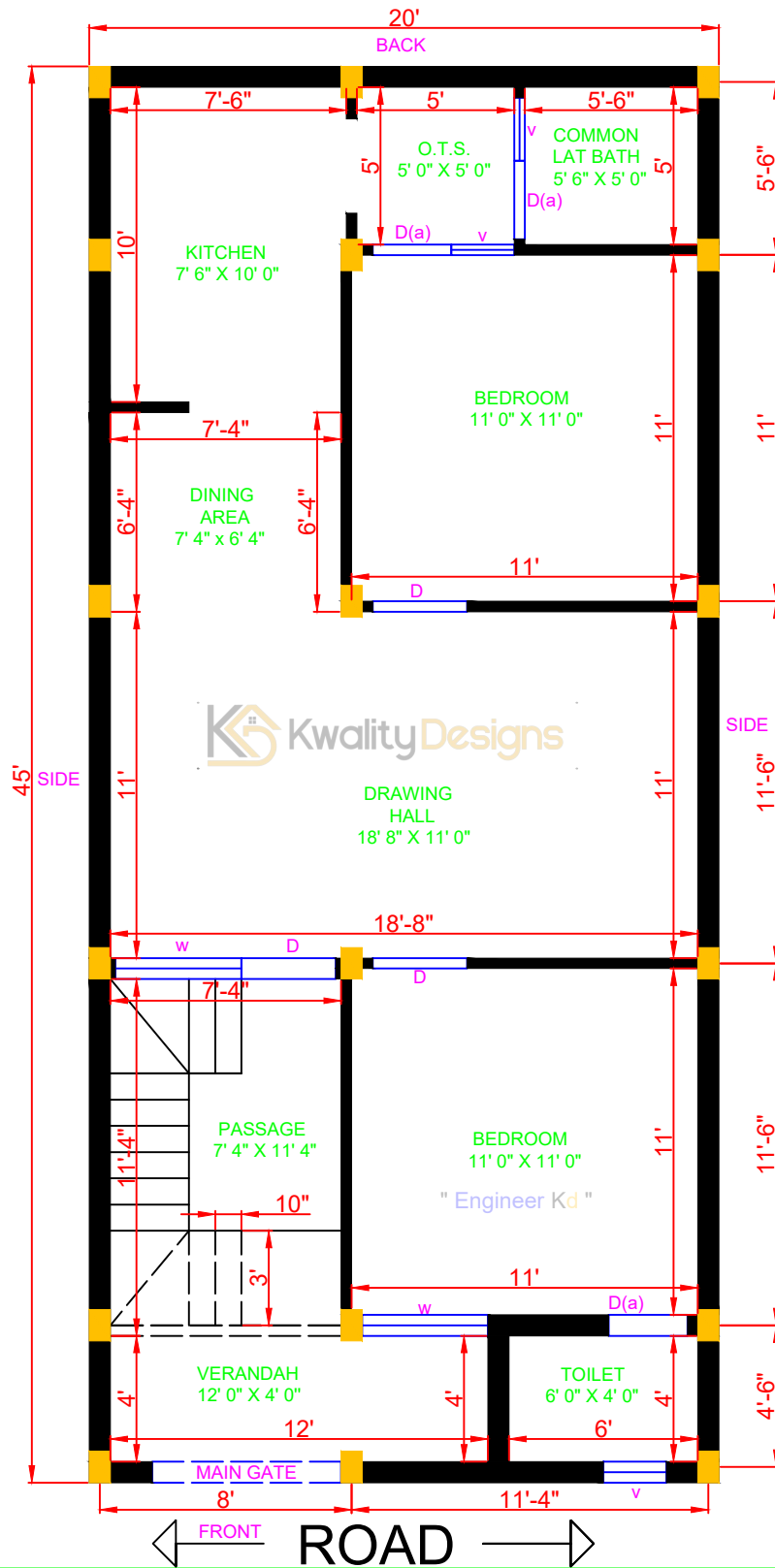

उत्तर मुखी घर का नक्शा



<b>2D PLAN DETAILS</b>	OUTER WALL- 8"	INNER WALL- 4"
COLUMN- 8" X 12"	STAIRS SIZE- 3' X 10"	MAIN GATE- 6' WIDE
DOOR (D)- 3' WIDE	DOOR D(a)- 2'6" WIDE	
WINDOW (w)- 4' WIDE	VENT (V)- 2' WIDE	CLIENT NAME : BHARAT CHAUHAN BANARAS



www.kwalitydesigns.com  
 engineerkdhome@gmail.com  
 "Engineer Kd"   
 Page & Channel Available on Instagram, Facebook & Youtube